

CAMP LOTTERY PROCEDURE

- ❖ SIGN IN, PAY THE \$50 REGISTRATION FEE, AND GET A NUMBER BEFORE 9:00 A.M. (CASH ONLY FOR REG.)
- ❖ ANY LATE ARRIVALS (AFTER 9:00 A.M.) WILL BE IN A SEPARATE LOTTERY AFTER THE GENERAL LOTTERY, PROVIDING THAT THERE ARE STILL VACANT CAMPSITES LEFT FROM THE LIST PROVIDED FOR THE LOTTERY.
- ❖ CHECK LIST OF AVAILABLE CAMP SITES AND LOCATIONS
- ❖ TRY AND HAVE SEVERAL LOTS IN MIND TO PICK FROM BEFORE YOUR NUMBER / NAME ARE CALLED TO PICK A LOT.
- ❖ REMEMBER THAT IT IS YOUR RESPONSIBILITY TO MAKE SURE THAT YOUR CAMPER OR TENT FITS IN THE LOT THAT YOU ARE RENTING.
- ❖ REMEMBER YOU ARE ONLY ALLOWED ONE CAMPSITE PER FAMILY. THIS MEANS ONLY ONE LOTTERY NUMBER ALSO. (NO GETTING MORE THAN ONE NUMBER TO BETTER YOUR CHANCES FOR A LOT.)
- ❖ CASS COUNTY FAIR IS NOT RESPONSIBLE FOR ANY ELECTRICAL SERVICE OVER 30 AMPERES FOR CAMPERS.
- ❖ DRIVERS LICENSE OR LEGAL PICTURE ID REQUIRED TO REGISTER FOR LOTTERY.

PROMPTLY AT 9:00 A.M. THE 1ST LOTTERY WILL BEGIN IN THE AUCTION OFFICE. THIS LOTTERY IS FOR ANY DISPLACED CAMPER THAT RECEIVED A LETTER FOLLOWED BY SUPERINTENDENTS. THEY WILL HAVE THE FIRST PICK OF ANY CAMPSITES THAT ARE OPEN ON THE LIST PROVIDED. IMMEDIATELY FOLLOWING, WE WILL BEGIN WITH THE GENERAL CAMP LOTTERY.

WHEN YOU SIGN IN, WE WILL RECORD YOUR LOTTERY NUMBER AND ASK WHO THE LOT IS BEING PURCHASED FOR / UNLESS YOU HAVE PRIOR APPROVAL THAT IS OKED THROUGH THE FAIR OFFICE YOU CAN NOT PURCHASE A CAMP LOT FOR ANYONE ELSE BUT YOURSELF.

ANY CAMP LOT RENTED AFTER 6/24/23 WILL BE A 1 YR. RENTAL WITH NO RENEWAL.

N

W

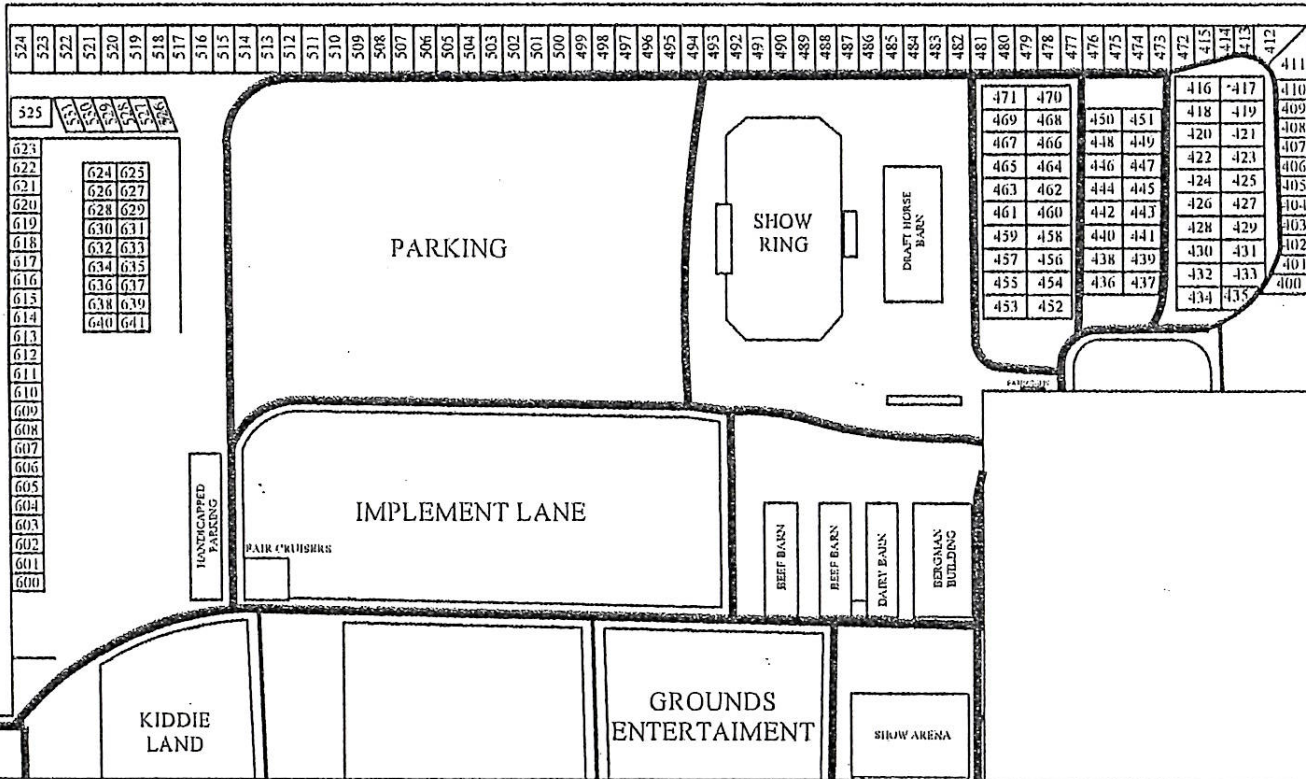

524
523
522
521
520
519
518
517
516
515
514
513
512
511
510
509
508
507
506
505
504
503
502
501
500
499
498
497
496
495
494
493
492
491
490
489
488
487
486
485
484
483
482

623
622
621
620
619
618
617
616
615
614
613
612
611
610
609
608
607
606
605
604
603
602
601
600

624	625
626	627
628	629
630	631
632	633
634	635
636	637
638	639
640	641

471	470
469	468
467	466
465	464
463	462
461	460
459	458
457	456
455	454
453	452

450	451
448	449
446	447
444	445
442	443
440	441
438	439
436	437

416	417
418	419
420	421
422	423
424	425
426	427
428	429
430	431
432	433
434	435

E

Z

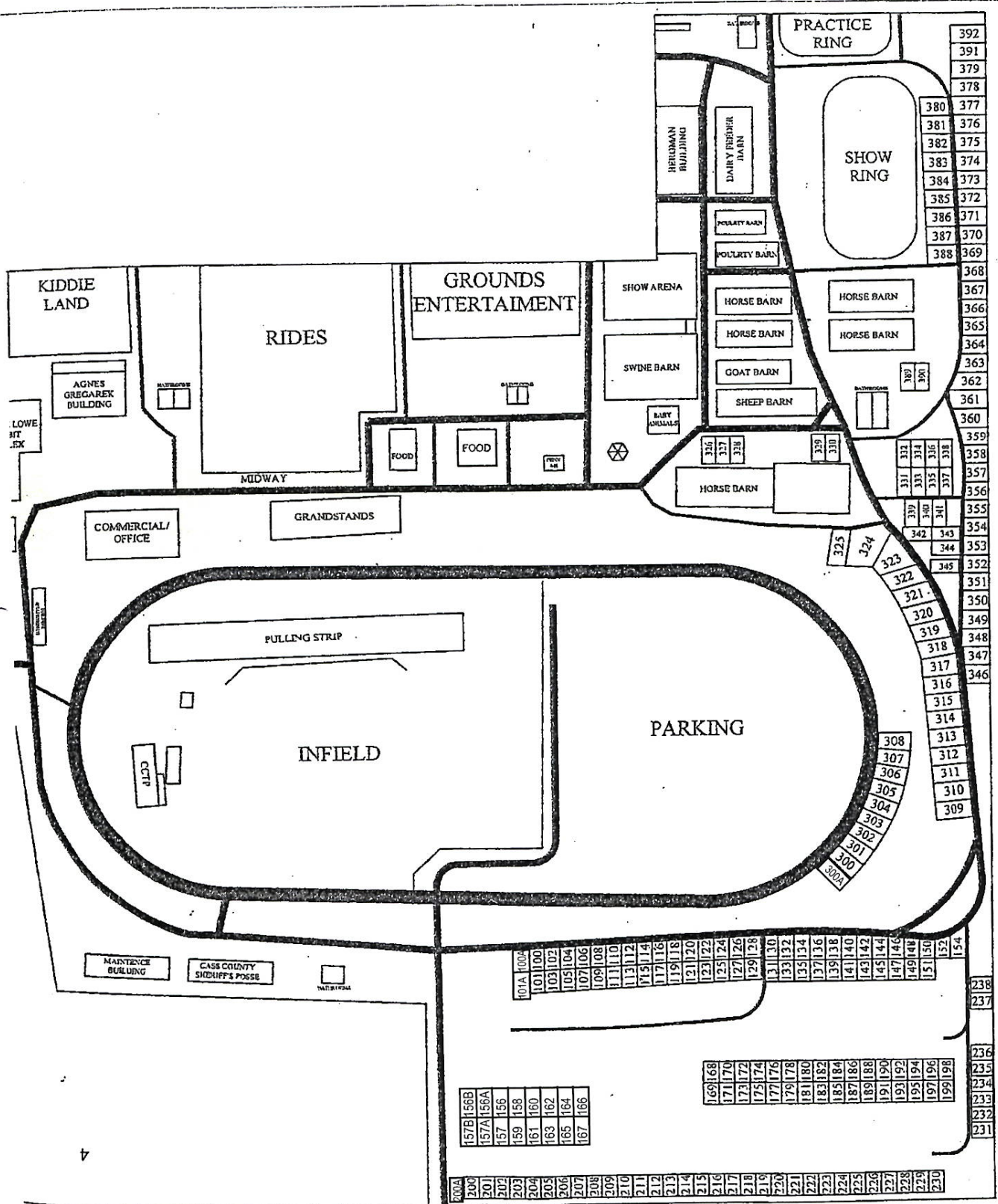

MTT

5

	A	C	E	F
1	2023 Lottery			
2	LOT #	RENEWABLE	1 YR	LOT# TRADED IN
3	100	X		
4	100A		X	
5	101A	X		
6	108		X	
7	111	X		
8	113	X		
9	115		X	
10	125	X		
11	126	X		
12	132		X	
13	137	X		
14	142	X		
15	150		X	
16	156A	X		
17	156B		X	
18	157A	X		
19	158		X	
20	159		X	
21	160		X	
22	161		X	
23	162		X	
24	163		X	
25	173	X		small camper
26	187		X	
27	200	X		
28	200A		X	
29	203	X		
30	204	X		
31	206	X		
32	223		X	
33	224	X		
34	227	X		
35	235	X		
36	331		X	

2022 CAMPING LOTTERY

	A	C	E	F
1	2023 Lottery			
2	LOT #	RENEWABLE	1 YR	LOT# TRADED IN
37	348	X		
38	349	X		
39	355		X	
40	358		X	
41	372	x		
42	374	X		
43	384	X		
44	386	X		
45	392	X		
46	406	X		
47	413		X	
48	414	X		
49	418	X		
50	438	X		
51	444		x	
52	461	X		
53	471	X		
54	478	X		
55	494	X		
56	499		X	